



Proudly Made
in the USA



18150-1 Power Panel Installation, 12VDC Power and Ground Instructions:

1. Remove Hood
2. Remove 2ea. Dash screws using Torx bit.
3. Lift Dash & unplug cables for (1) 12V Cigarette/Power, (2) Speedometer, (3) 2x4, 4x4 Switch & (4) Headlights.
4. Remove nut from ignition key housing and push thru dash.
5. Remove Dash from RZR.
6. Place 18150-1 Power Panel on RZR as shown in Figure 1 & secure to RZR frame using the 4 supplied self-tapping stainless steel screws as shown in Figure 2.

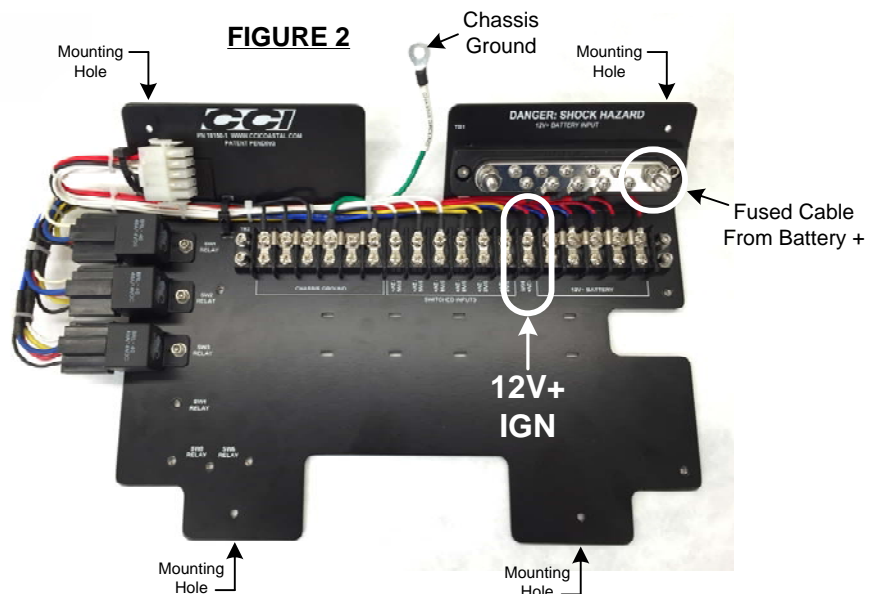
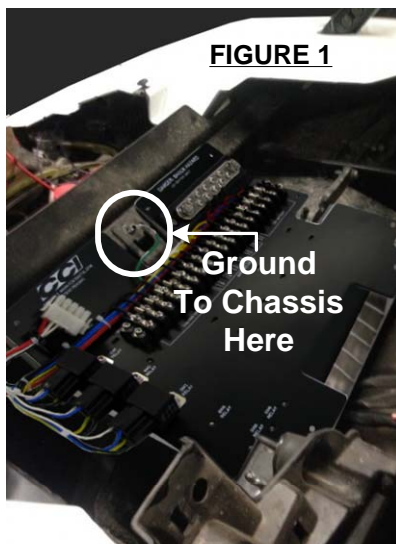

7. Install the 18150-1's Chassis Ground ring lug to the RZR's frame existing bolt as shown in Figure 1.
8. Install a fused power cable (Not Included) from the battery's positive terminal to the 1/4" bolt on the 18150-1's TB1, see Figure 2, & immediately install the protective cover to TB1. **Caution:** Make sure you use an in-line fuse between your battery and the 18150-1's TB1. Your 18150-1 is now fully powered.



Proudly Made in the USA

- Route the wire from the 18150-1's TB2 screw labeled as "12V+ IGN", see Figure 2, to the RZR's factory terminal labeled as "ACC" as shown in Figure 3. This is only used by the 18150-1 to power the Contura V switches internal LED lights.

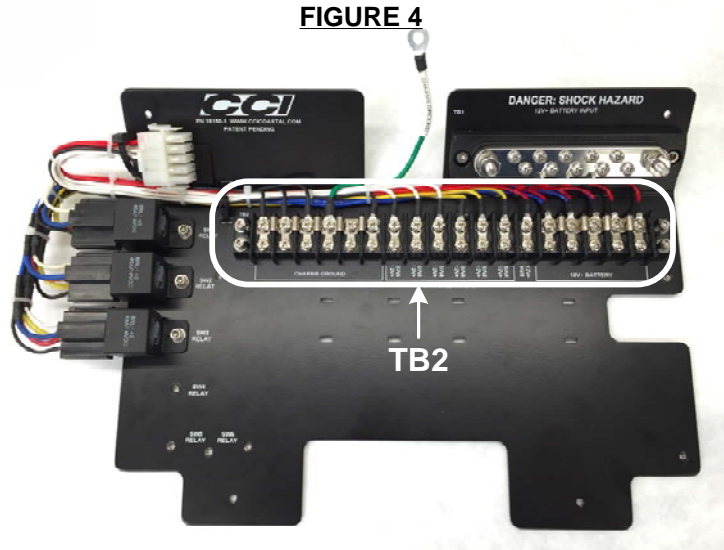

The 18150-1's terminal block TB2, (See Figure 4), is where you will power and control all of your RZR's aftermarket accessories. There are also several spare 12VDC Power and Ground locations for aftermarket accessories that do not require a dash mounted switch, such as Intercom Systems, Car to Car Radio's, etc (See Figure 6).

Powering up your aftermarket accessories with dash mounted Contura V Type switches (Not included with standard kit):

Looking at the 18150-1 Power Panel's TB2 terminal, make note of the terminal's section identified as "SWITCHED INPUTS". SW1 thru SW6 12V+ represents Switch#'s 1 thru 6 on your dash. The 18150-1 comes pre-wired with 3ea. Hi-Power Relays for your LED lights. These Hi-Power relays for Switch 1 thru Switch 3 locations on the 18150-1 Power Panel correspond with 3ea. branches on 18150-1B cable harness, (See Figure 9), that will plug into the rear of the Contura V switch. These Hi-Power relays can also be used for low power applications.

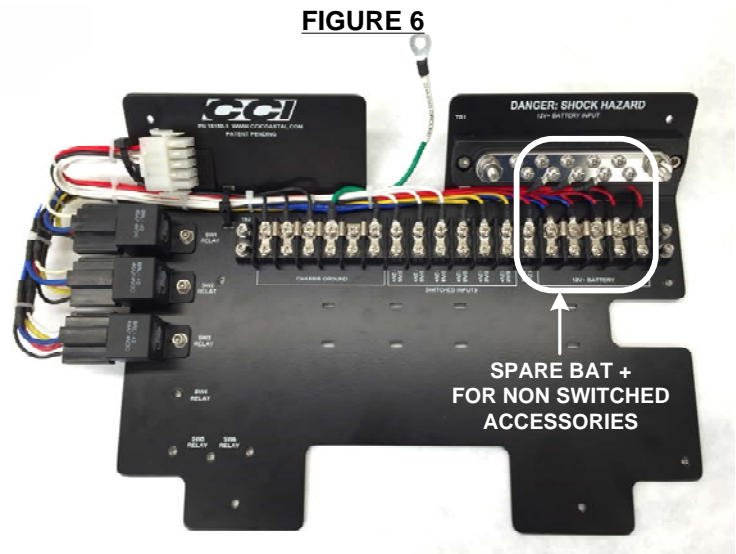
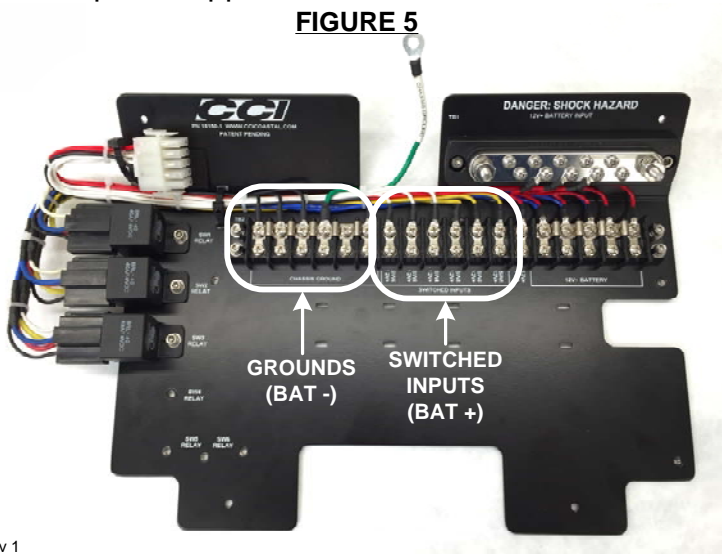



Proudly Made
in the USA

FIGURE 7

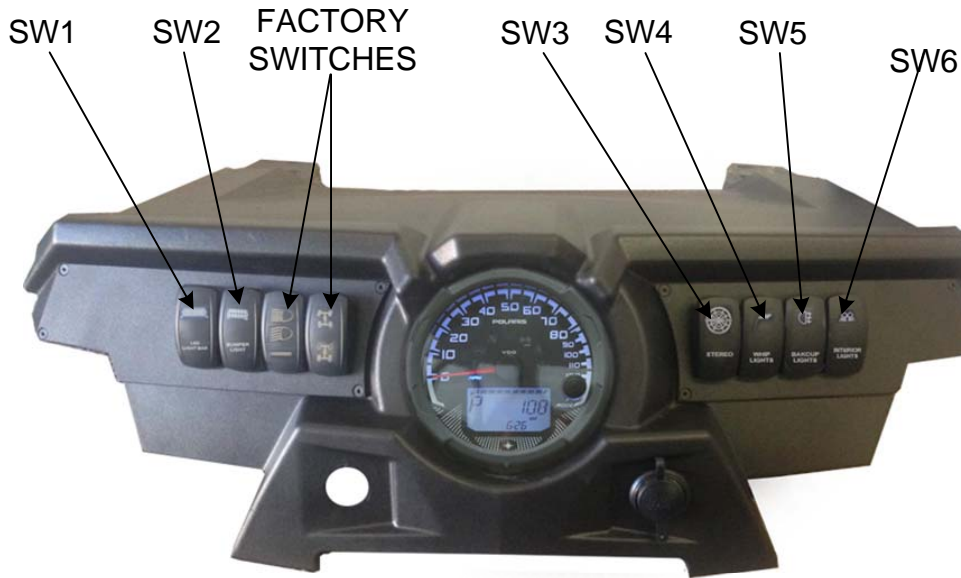

1. Connect the Ground wire to any Chassis Ground screw on TB2.
2. Connect the switched accessory positive (Bat +) wire to in-line fuse holder connected to SW1 terminal on 18150-1's TB2.
3. Install fuse into in-line holder, (See Figure 8), that is rated by the accessory's manufacturer.
4. Plug the 18150-1B's connector label SW1 to the SW1 Contura V switch mounted in your dash.
5. The SW1 switch will now operate the accessory.
6. Repeat for all additional switched accessories.

FIGURE 8

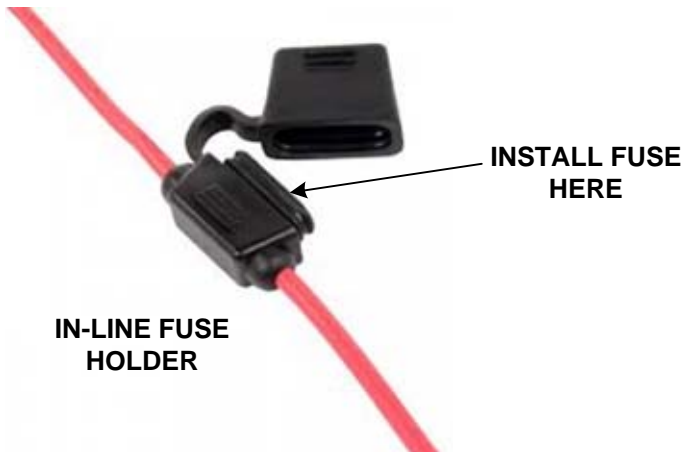
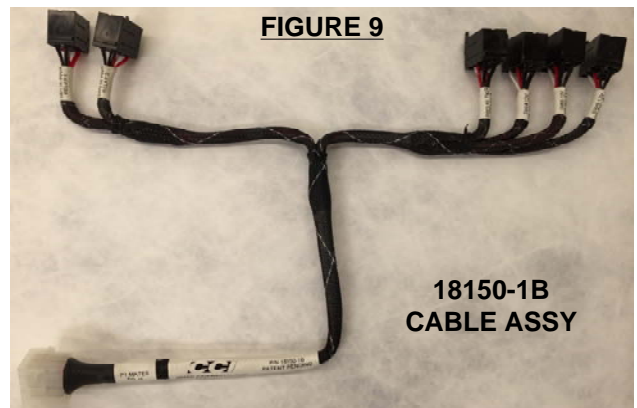

FIGURE 9



Contura V Switches and Switch Mounting Plates are available separately. Please email CCI with your requirements and we will be happy to support you.

sales@ccicoastal.com www.ccicoastal.com Orange, CA, USA